

◆ MODEL 型 式

MRV-02-P



◆ FEATURES

- MRV series modular relief valves can be used to efficiently restrict the "P" port, "A" port, or "B" port or the pressure from "A" and "B" port to the oil tank.
- Casting iron valve bodies are provided strength and durability for longer life.
- Internal hardened steel components also provide durable life.
- Four standard pressure setting options are available.
- Two pressure adjustment options are: hex. screw or knob.

- 特 點
- MRV系列積層型調壓閥可使用 P孔、A孔、B孔或 A-B孔至油箱。
- 積A-B孔交叉有效限制壓力。
- 鑄本體鋼結構強度夠且耐久性、壽命長。
- 內部硬鋼零件提高產品壽命。
- 四種標準壓力設定選擇。
- 六角螺絲或把手兩種壓力調整選擇。

◆ SPECIFICATIONS 規 格

Model Number 型式號碼	Maximum Pressure 最大壓力 bar	Connecting PT 適用管徑	Maximum Flow 最大流量 lpm	Weight 重量 Kg
MRV-02-P, A, B	315 (4500 psi)	1/4"	40 (10.56 gpm)	1.5 (3.3 lbs)
MRV-02-W				2 (4.4 lbs)
MRV-02-C	315 (4500 psi)	1/4"	20 (5.28 gpm)	2 (4.4 lbs)
MRV-02-D				1.8 (4.0 lbs)
MRV-02-AD				
MRV-02-BD				
Fluid Type 液體型式		ISO VG 32, 46, 68		
Viscosity 黏性 cSt		10-400 (59-1854 SSU)		
Operating Temperature 操作溫度 °C		-15~70 (-5~158°F)		
Contamination Level 污染標準		ISO4406. 21/19/16 NAS:1638,10		
Surface Treatment 表面處理		Zinc Phosphate Compound 磷醯鹽 化合物		

- All screws with metric measure, if require inch measure, please contact us.

※附錄表格為公制標準規格值，若需要制英制規格請另向經銷商洽詢。

◆ HOW TO ORDER 編號說明

1	2	3	4	5	6	7
MRV	02	P	1	K	L	20

1 VALVE SERIES 系列名稱

MRV=Relief Modular Valves

4 PRESSURE ADJUSTMENT 壓力調整範圍

- | | |
|-----------------|-----------------|
| P . A . B . W | C . D . AD . BD |
| 1. * ~ 70 (bar) | 1. * ~ 70 (bar) |
| 2. 8~140 (bar) | 2. 10~210 (bar) |
| 3. 10~250 (bar) | |
| 4. 20~315 (bar) | |

2 SUBPLATE MOUNTING SIZE: 安裝口徑

02 = 1/4"(6mm)
ISO CETOP3
DIN NG 6
NFPA D03

5 SHAPE 調整螺絲形狀

NONE: TOOL ADJUST 無，工具調整式
KHAND-BAR ADJUST K: 手把調整式

6 ORIENTATION 調整器方向

NONE: B ORIENTATION (Standard)
L: A ORIENTATION
無: B方向(標準型)
L: A方向

3 CONTROL PORT(S) 動作形式

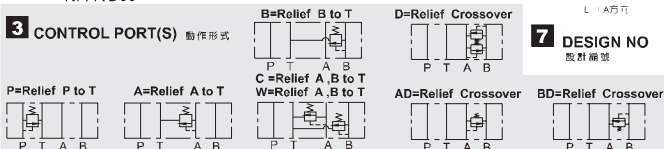

7 DESIGN NO 設計編號

RELIEF MODULAR VALVES

MRV SERIES

稱量型調壓閥

◆ PERFORMANCE 性能

Test Conditions 測試條件

Oil Temperature 油溫度: 50°C(122°F)

Viscosity 黏度: 35 cSt (163 SSU)

MRV-02

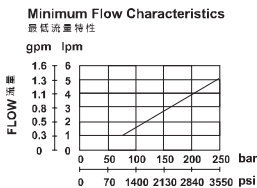
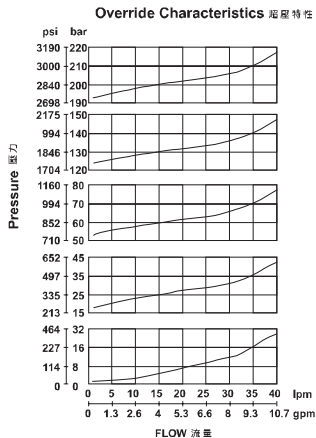
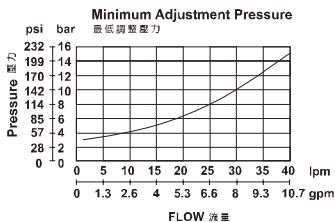
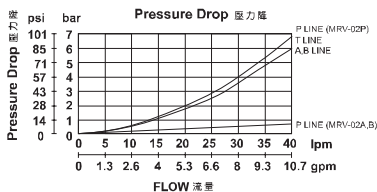

● Pressure Setting

Facing to adjustment screw or knob, clockwise increasing pressure, counterclockwise decreasing pressure. Please tighten hex. nut or plastic setting nut after pressure adjusted.

● 壓力設定:

調整螺絲或把手順時鐘方向調整壓力增強, 逆時鐘方向調整壓力減弱。
壓力調整後請鎖緊六角螺帽或塑膠安裝螺帽。

◆ DIMENSIONS 外形尺寸圖

MRV-02-*

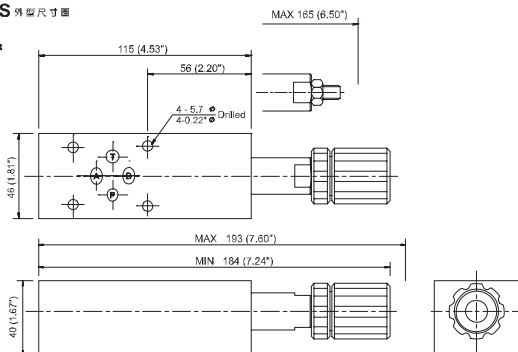

MRV-02-*-L

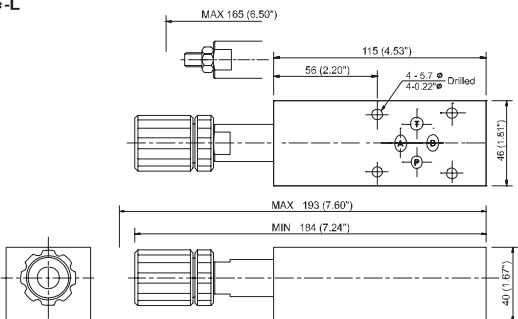

MRV-02-W

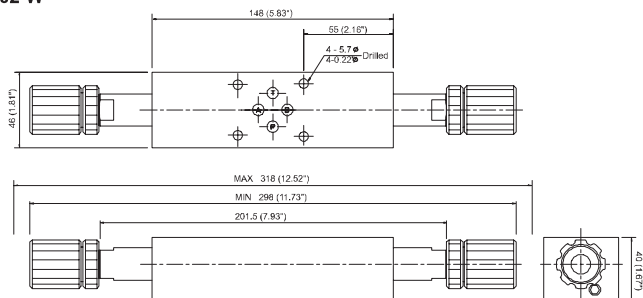

RELIEF MODULAR VALVES

MRV SERIES

積層型剎車閥

◆ DIMENSIONS 外型尺寸圖

MRV-02-C, D

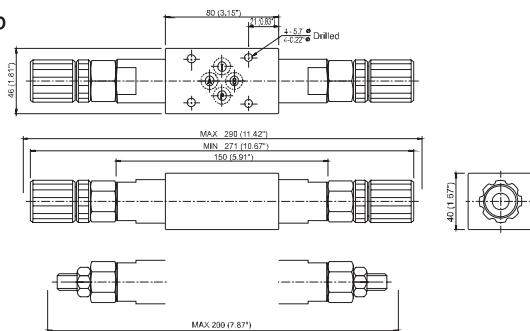

MRV-02-AD

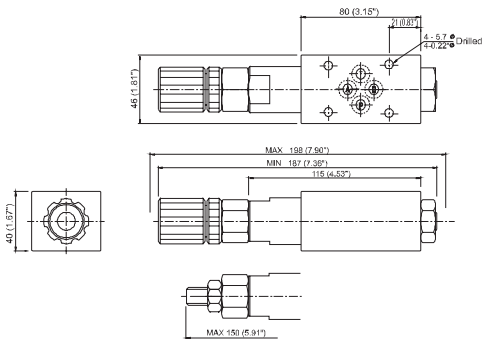

MRV-02-BD

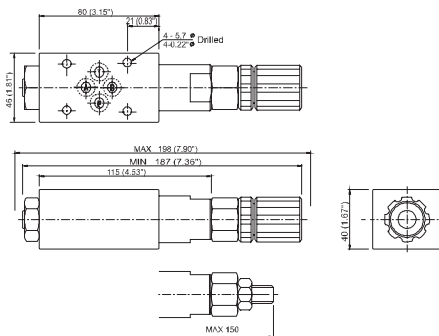

◆ Mounting Interface 基礎尺寸圖

ISO 4401-AB-03-4-A

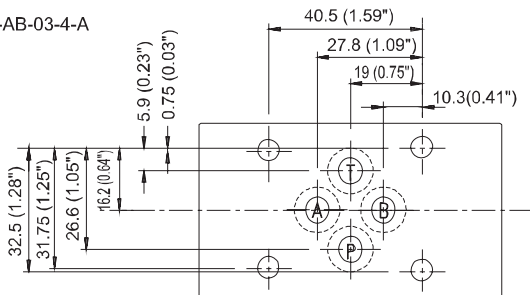

◆ PARTS LIST OF MRV-02 SERIES 零件爆炸視圖

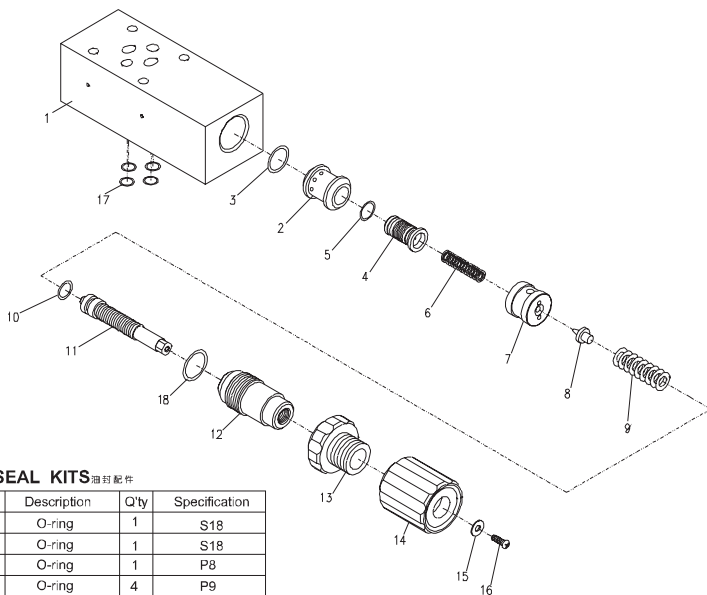

◆ SEAL KITS 密封配件

NO	Description	Q'ty	Specification
3	O-ring	1	S18
5	O-ring	1	S18
10	O-ring	1	P8
17	O-ring	4	P9
18	O-ring	1	P16