

PILOT OPERATED DIRECTIONAL VALVES

引導式方向閥

DS-02G SERIES

A
DS

◆ MODEL 型 式

DS-02G

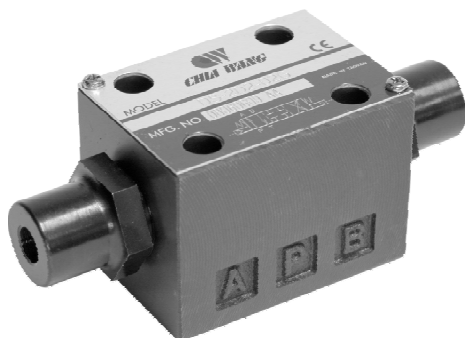

◆ FEATURES

- Casting iron valve bodies are provided strength and durability for longer life.
- Internal hardened steel components also provide durable life.

特 點

- 閥本體鑄鐵強度夠且耐久性，壽命長。
- 內部硬鋼原件提高產品壽命。

◆ SPECIFICATIONS 規 格

Model Number 型式號碼	Maximum Pressure 最大壓力 bar	Maximum Piloed Pressure 最大引導壓力 Bar	Maximum Flow 最大流量 lpm	Weight 重量 Kg
DS-2D * -02G-A	315 (4569 psi)	3~12	100(26.42gpm)	2.1 (4.63 lbs)
DS-3C * -02G-A				2.1 (4.63 lbs)
DS-2D * -02G-B		250		1.5 (3.31 lbs)
DS-3C * -02G-B				1.5 (3.31 lbs)
Fluid Type 流體型式		ISO VG 32 , 46 , 68		
Viscosity 黏性 cSt		10~400 (59~1854 SSU)		
Operating Temperature 操作溫度 °C		-15~70 (-5~158 °F)		
Contamination Level 污染標準		ISO4406. 21/19/16 NAS1638,10		
Surface Treatment 表面處理		Zinc Phosphate Compound 鋅 磷酸鹽 化合物		

- All screws with metric measure , if require inch measure , please contact us.

所附螺絲皆為公制標準規格品，若需英制螺絲請另外備註說明。

◆ HOW TO ORDER 編號說明

1	2	3	4	5
DS	***	02	G	*

1 VALVE SERIES 系列名稱

DS=Pilot Operated Check Vales

2 GRAPHIC SYMBOL 圖表符號

3C2 	3C3 	3C4 	3C5
3C6 	3C10 	3C11 	3C12
3C60 	2B2 	2B3 	2D2

3 SUBPLATE MOUNTING SIZE: 稱呼口徑

02=1/4"(6mm)

ISO CETOP3

DIN NG 6

NFPA D03

4 CONNECTING TYPE 連接型式

G:TYPE:BASEPLATE MOUNTING TYPE

G:(板式連接)

5 PILOTED WAY 導引方式

A:PNEUMATIC PILOTED

A:(空壓導引)

B:HYDRAULIC PILOTED

B:(液壓導引)

PILOT OPERATED DIRECTIONAL VALVES

DS-02G SERIES

引導式方向閥

A
DS

◆ DIMENSIONS 外型尺寸圖

DS-02G-A

● Mounting Interface 安裝板面

ISO 4401-AB-03-4-A

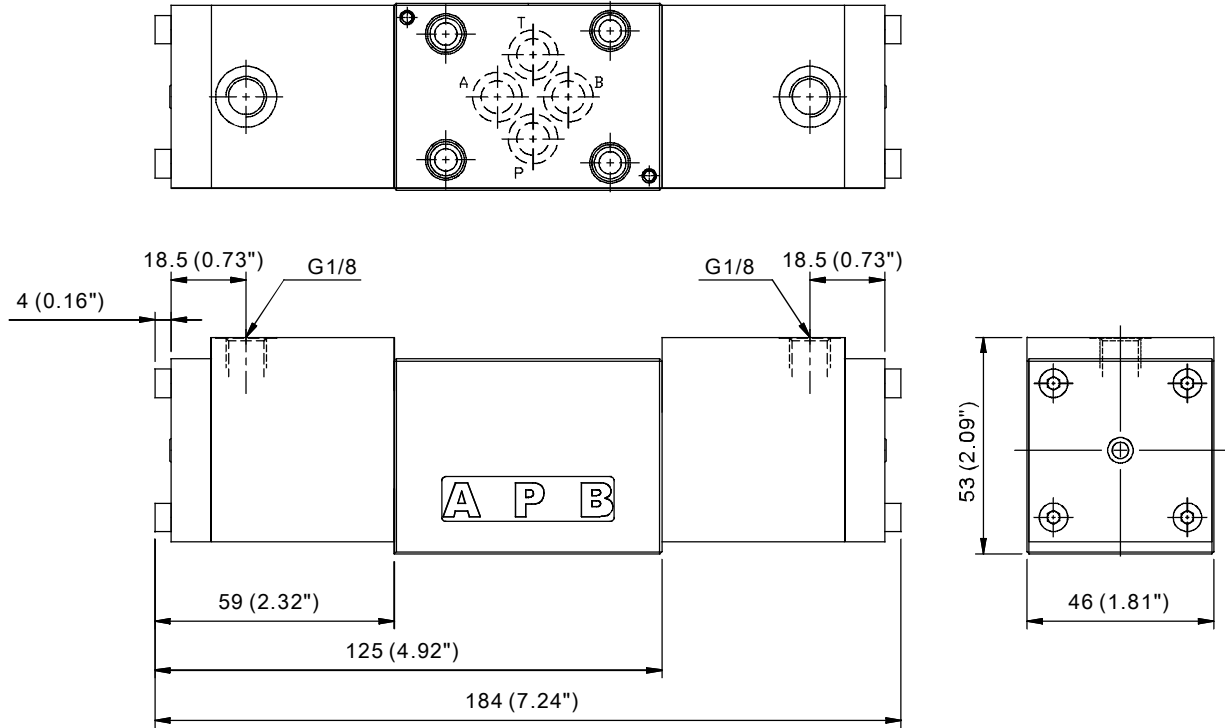

◆ DIMENSIONS 外型尺寸圖

DS-02G-B

● Mounting Interface 安裝板面

ISO 4401-AB-03-4-A

