

SOLENOID CONTROLLED PILOT OPERATED DIRECTIONAL VALVES

DS SERIES

電磁換向閥

MODEL 型式

DS-06

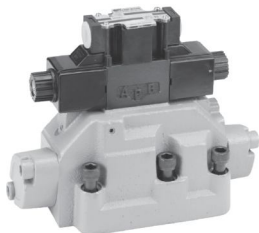

SPECIFICATIONS 規格

Model Number 型式號碼	Maximum Pressure 最大壓力 bar	Connecting PT 進用管徑	Back Pressure-"T" 背壓-"T" bar	Maximum Flow 最大流量 lpm	Weight 重量 Kg (Weight exclude solenoid valves 重量不含電磁閥)
DS-04G	250 (3625 psi)	1/2"	210 (3046psi)	200 (52.8 gpm)	7.9 (17.42 lbs)
DSH-04G	350 (5076 psi)		250 (3626psi)	300 (79.25 gpm)	7.9 (17.42 lbs)
DS-06G	350 (5076 psi)	3/4"	250 (3626psi)	500 (132 gpm)	13.5 (29.76 lbs)
DS-10G	250 (3625 psi)	1-1/4"	210 (3046psi)	1100 (290 gpm)	51.6 (113.75 lbs)
Fluid Type 液體型式				ISO VG 32, 46, 68	
Viscosity 黏性 cSt				10-400 (59-1854 SSU)	
Operating Temperature 操作溫度 °C				-15-70 (-5-158°F)	
Contamination Level 污染標準				ISO4406. 21/19/16 NAS1638.10	

● All screws with metric measure, if require inch measure, please contact us.

所有螺絲皆為公制標準規格者，若需英制螺絲請與外係註明。

HOW TO ORDER 編號說明

1	2	3	4	5	6	7	8	9
DS	—3C2	—04	—G	—*	—*	—**	—**	—30

1 VALVE SERIES 系列名稱

DS= Solenoid Controlled Pilot Operated Directional Valves

2 GRAPHIC SYMBOL 圖表符號

3C2 	3C3* 	3C4
3C10 	3C5* 	3C6*
3C60* 	3C12 	3C11
2B2 	2B3* 	2D2

3 SUBPLATE MOUNTING SIZE: 騎穿口徑

04 = 1/2"(12mm) ISO CETOP7
DIN NG 16
NFPA D07

06 = 3/4"(19mm) ISO CETOP8
DIN NG 25
NFPA D08

10 = 1 1/4"(31.8mm) ISO CETOP10
DIN NG 32
NFPA D10

4 CONNECTING TYPE 連接型式

G:TYPE:BASEPLATE MOUNTING TYPE (板式連接)

5 RELEASE WAY 排洩方式

NONE:INNER T:OUTER
排洩方式 無:內部 T:外部

6 PILOT OPERATED WAY 引導壓力方式

NONE:INNER E: OUTER
引導壓力方式 無:內部 E:外部

7 ADJUSTING WAY 調整方式

NONE:STANDARD AK:A ADJUST 螺紋調整 AK:A調整
BK:B ADJUST WK:A,B ASJUST BK:B調整 WK:A,B調整

8 COIL TYPES OF SOLENOID VALVE

電磁閥電壓線圈類型
A1 : AC110 60HZ D1 : DC12
A115 : AC115 50HZ D2 : DC24
A230 : AC230 50HZ R1 : RF110 60HZ/50HZ
A2 : AC220 60HZ R2 : RF220 60HZ/50HZ

9 WIRING TYPE 接線型式

20: WIRING BOX TYPE 接線盒式
30: DIN TYPE D: I型

SOLENOID CONTROLLED PILOT OPERATED DIRECTIONAL VALVES

電磁換向閥

DS SERIES

◆ **PERFORMANCE** 性能 Test Conditions 測試條件
 Oil Temperature 油溫: 50°C (122°F)
 Viscosity 黏度: 35 cSt (163 SSU)

● DSH - 04

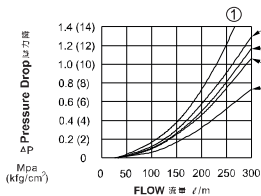

Curve Type 曲線形式	Pressure Drop Curve Number 壓力降曲線編號				
	P → A	B → T	P → B	A → T	P → T
2	⑤	③	⑤	③	—
6	④	②	⑤	③	①
4	⑤	③	⑤	③	—
10	⑤	③	⑤	③	—

● DS - 04

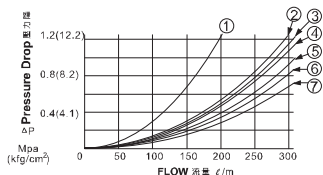

Curve Type 曲線形式	Pressure Drop Curve Number 壓力降曲線編號					Curve Type 曲線形式	Pressure Drop Curve Number 壓力降曲線編號				
	P → A	B → T	P → B	A → T	P → T		P → A	B → T	P → B	A → T	P → T
2	⑤	②	⑤	②	⑥	60	⑦	⑥	⑦	⑦	②
3	⑤	③	⑤	⑤	⑦	7	⑤	④	⑤	⑥	—
4	⑤	③	⑤	②	⑤	9	⑤	④	⑤	⑥	—
40	⑤	②	④	⑦	⑤	10	⑤	②	②	⑤	②
5	⑦	④	⑤	⑤	⑥	11	⑥	④	⑤	⑥	—
6	⑤	③	④	⑤	⑥	12	⑤	②	④	⑤	⑤

● DS - 06

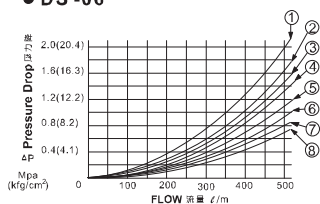

Curve Type 曲線形式	Pressure Drop Curve Number 壓力降曲線編號					Curve Type 曲線形式	Pressure Drop Curve Number 壓力降曲線編號				
	P → A	B → T	P → B	A → T	P → T		P → A	B → T	P → B	A → T	P → T
2	⑧	⑥	⑤	⑧	⑦	60	⑥	⑤	②	⑥	③
3	⑥	④	⑥	⑦	⑥	7	⑥	④	⑥	⑦	—
4	⑧	⑥	⑤	②	⑧	7	②	⑥	⑤	⑥	⑦
40	⑧	⑤	⑧	⑦	—	9	⑥	⑤	⑥	⑦	—
5	⑧	④	⑤	⑦	②	11	⑧	④	⑤	⑦	—
6	⑤	①	⑤	④	③	12	⑧	⑤	⑧	⑦	—

● DS - 10

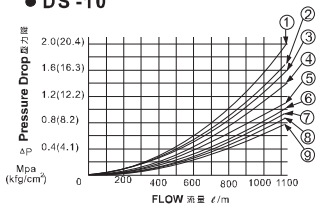

Curve Type 曲線形式	Pressure Drop Curve Number 壓力降曲線編號					Curve Type 曲線形式	Pressure Drop Curve Number 壓力降曲線編號				
	P → A	B → T	P → B	A → T	P → T		P → A	B → T	P → B	A → T	P → T
2	⑨	⑧	⑥	③	⑧	60	⑧	⑧	⑤	④	⑧
3	⑦	⑥	⑦	⑦	⑤	7	⑦	⑥	⑦	⑦	—
4	⑨	⑧	⑥	⑤	⑧	9	⑦	⑥	⑦	⑧	—
40	⑨	⑥	⑥	⑨	⑧	10	⑨	⑤	⑨	⑧	—
5	⑨	⑥	⑥	⑥	①	11	⑨	⑥	⑥	⑦	—
6	⑤	③	⑤	④	②	12	⑨	⑦	⑨	⑥	—

A
DS

SOLENOID CONTROLLED PILOT OPERATED DIRECTIONAL VALVES

DS SERIES

電磁換向閥

◆ SECTION 剖面圖

DS-***-04G-A*-20

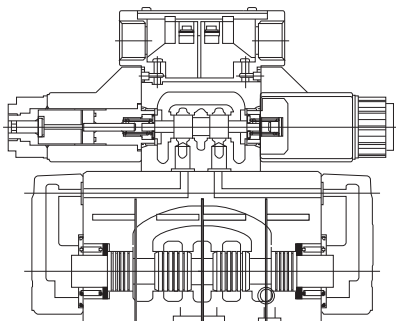

內部回油時，須將螺絲拆除
Without Plug When Valve
Is Internally Drained.

外部回油時，須將螺絲鎖入
With Plug When Valve
Is Externally Drained.

內部導引時，須將螺絲拆除
Without Plug When Valve
Is Internally Piloted

外部導引時，須將螺絲鎖入
With Plug When Valve
Is Externally Piloted.

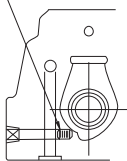

Y

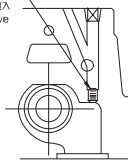

X

ACCESSORIES 附屬配件

DS-04G	HEX. COUNTER-SINK SCREW	4	M10 x 45L
		2	M6 x 40L
DSH-04G	HEX. COUNTER-SINK SCREW	4	M10 x 55L
		2	M6 x 55L
DS-06G	HEX. COUNTER-SINK SCREW	6	M12 x 65L
DS-10G	HEX. COUNTER-SINK SCREW	6	M20 x 70L

◆ DIMENSIONS 外觀尺寸圖

DS-***-04G-A*-20

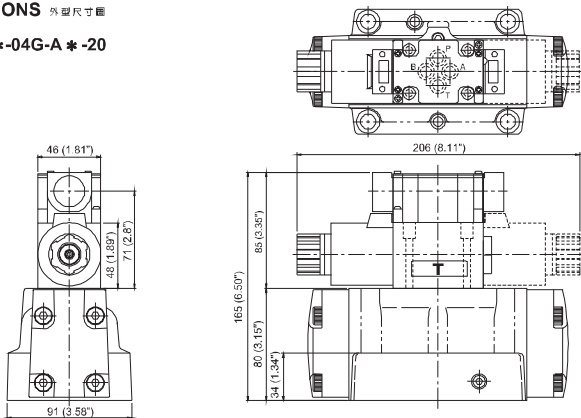

SOLENOID CONTROLLED PILOT OPERATED DIRECTIONAL VALVES

電磁換向閥

DS SERIES

◆ DIMENSIONS 外型尺寸圖

DS-***-04G-A*-30

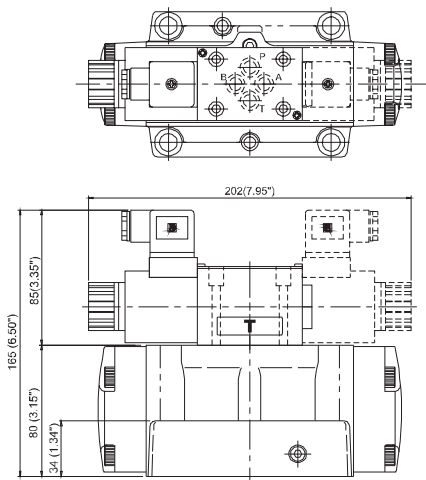
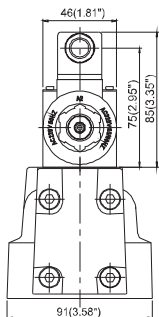

DS-***-04G-D*-20

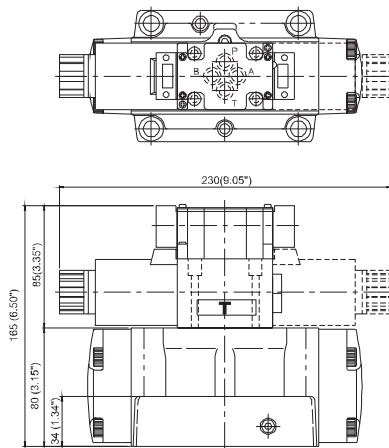
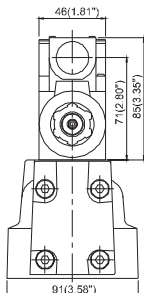

A
DS

SOLENOID CONTROLLED PILOT OPERATED DIRECTIONAL VALVES

DS SERIES

電磁換向閥

◆ DIMENSIONS 外型尺寸圖

DS-***-04G-D*-30

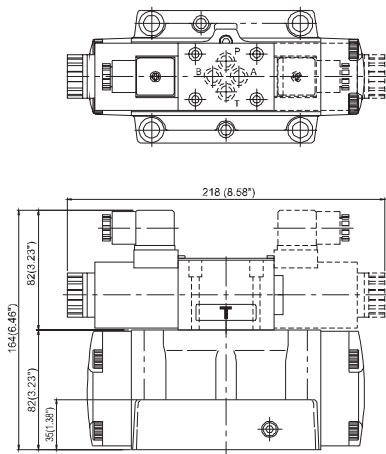
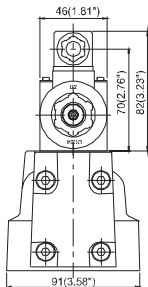

DS-***-04G-WK-D*-30

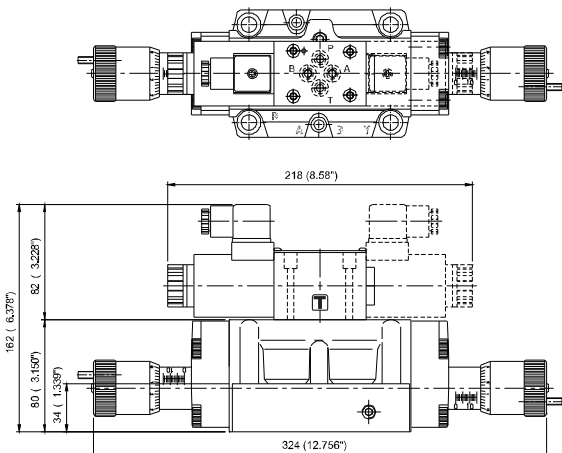
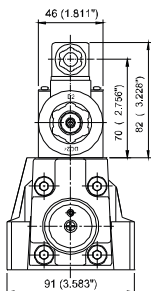

SOLENOID CONTROLLED PILOT OPERATED DIRECTIONAL VALVES

電磁換向閥

DS SERIES

◆ DIMENSIONS 外型尺寸圖

DSH-***-04G-A*-20

DSH-04G-WK-20

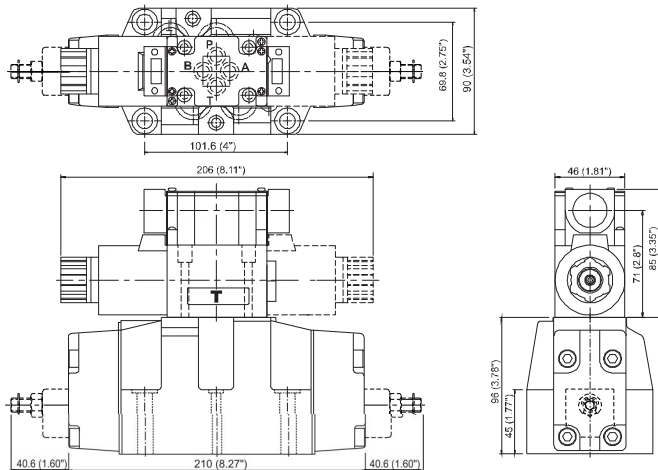

DSH-***-04G-A*-30

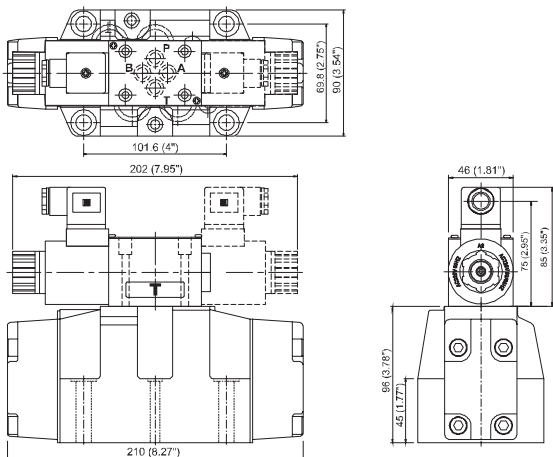

A
DS

SOLENOID CONTROLLED PILOT OPERATED DIRECTIONAL VALVES

DS SERIES

電磁換向閥

◆ DIMENSIONS 外型尺寸圖

DSH-***-04G-D*-20

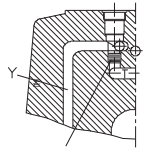
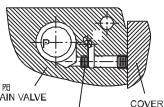
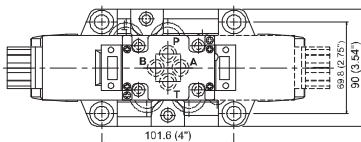

1. Without Plug (Please Release Screw) When Valve is Internally Piloted.
 1) 內置導引閥者請參照此款。
 2. P Hole W/Check Valve. (Please Release Screw) And To Be Outer Lead.
 2) 外導引: 皮爾諾閥或球閥類請參照此款以外導引型。

1. WITHOUT PLUG (PLEASE RELEASE SCREW) WHEN VALVE IS INTERNALLY DRAINED.
 1) 內置導引閥者請參照此款。

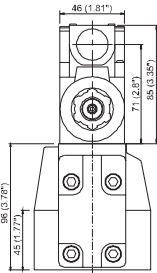
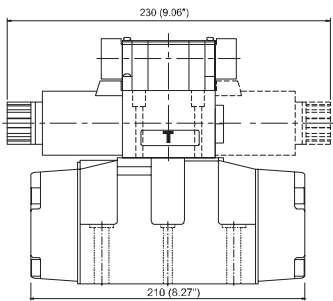

DSH-***-04G-D*-30

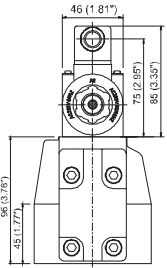
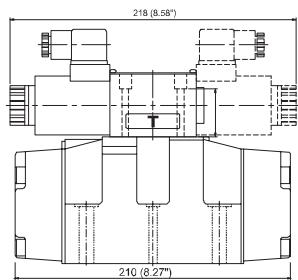
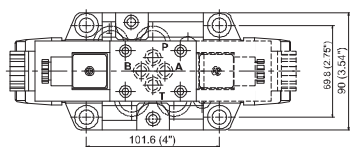

SOLENOID CONTROLLED PILOT OPERATED DIRECTIONAL VALVES

電磁換向閥

DS SERIES

◆ DIMENSIONS 外型尺寸圖

DS-***-06G-A*-20

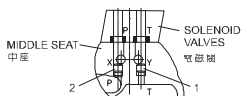

Take the plug 1 and 2 for using inner lead and inner release oil.
如需用內油引導和內部洩油孔把1,2塞裝在出口上

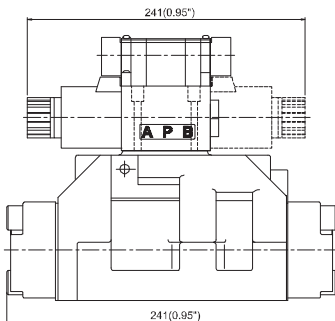
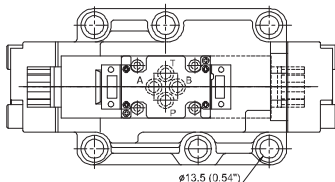
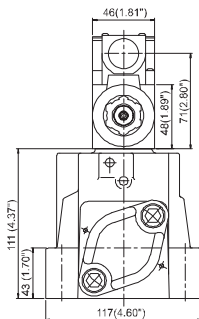

DS-***-06G-A*-30

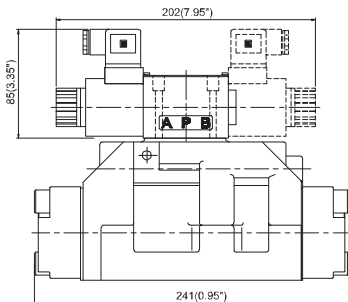
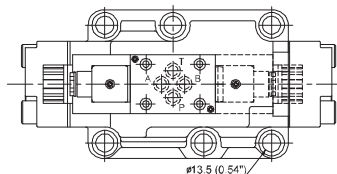
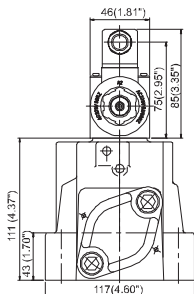

A
DS

SOLENOID CONTROLLED PILOT OPERATED DIRECTIONAL VALVES

DS SERIES

電磁換向閥

◆ DIMENSIONS 外形尺寸圖

DS-***-06G-D* -20

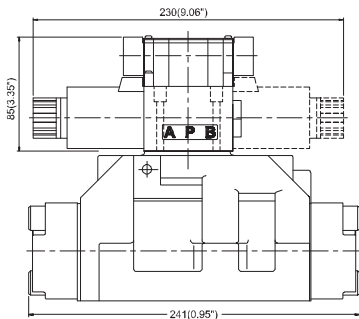
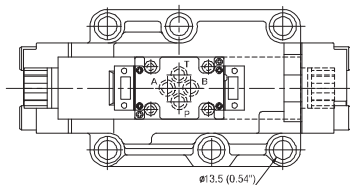
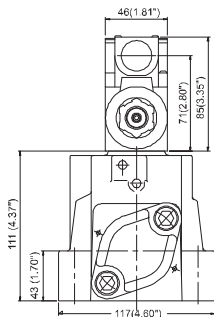

DS-***-06G-D* -30

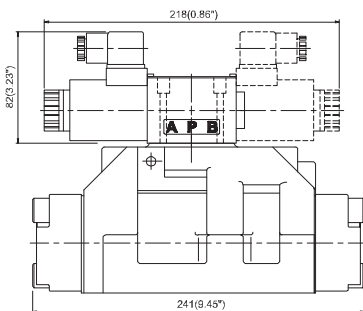
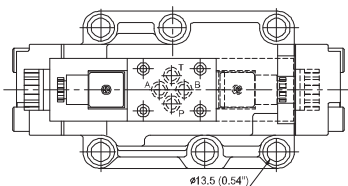
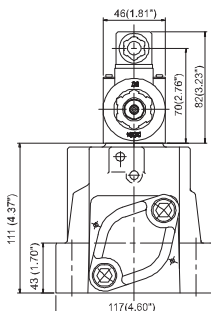

SOLENOID CONTROLLED PILOT OPERATED DIRECTIONAL VALVES

電磁換向閥

DS SERIES

◆ DIMENSIONS 外型尺寸圖

DS-***-06G-WK-D*-30

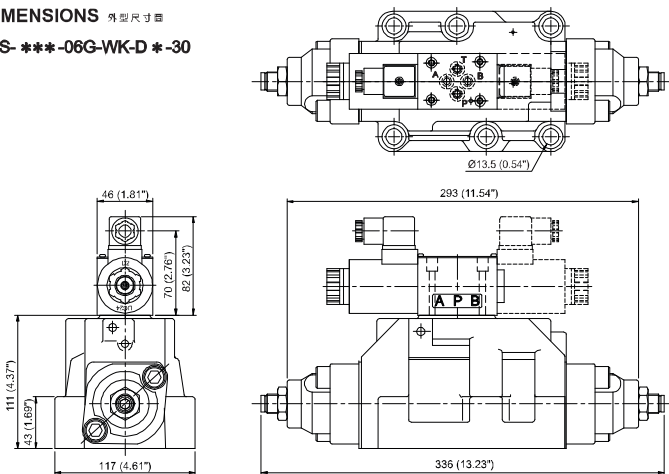

DS-***-10G-**-*

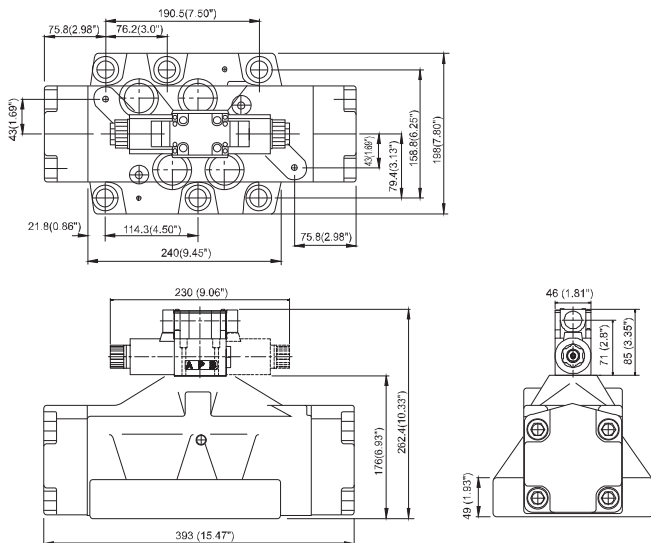

A
DS

SOLENOID CONTROLLED PILOT OPERATED DIRECTIONAL VALVES

DS SERIES

電磁換向閥



◆ Mounting Interface 基礎尺寸圖

DS-04G ISO 4401-AD-07-4-A

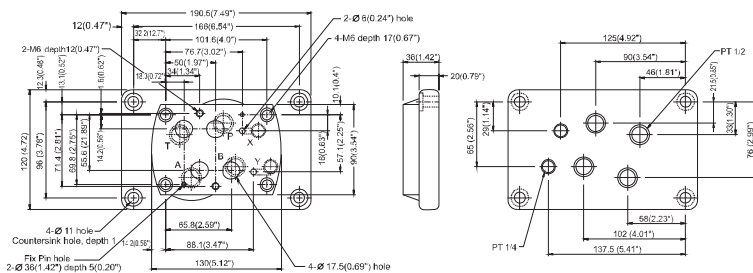

◆ Mounting Interface 基礎尺寸圖

DS-06G ISO 4401-AE-08-4-A

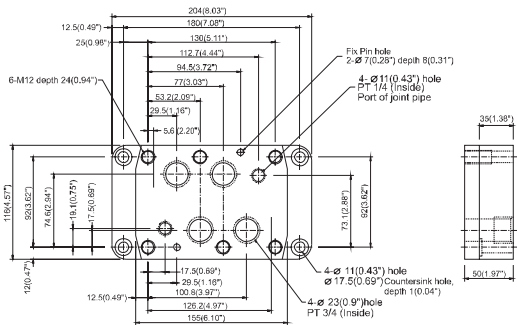

◆ Mounting Interface 基礎尺寸圖

DS-10G ISO 4401-AF-10-4-A

