

# CAM OPERATED DIRECTIONAL VALVES

**DCG - - GIV SERIES ( Position Switch Included )**

凸輪行程換向閥 ( 附位置感應器 )

## ◆ MODEL 型 式

**DCG-2B2-02G-10-GIV**

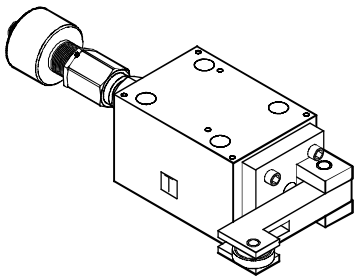

**DCG-2B2-02G-20-GIV**

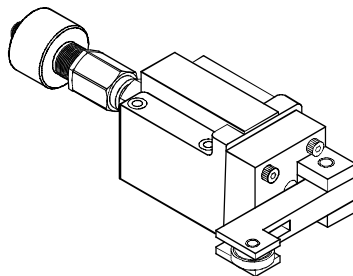

**DCG-2B2-03G-10-GIV**

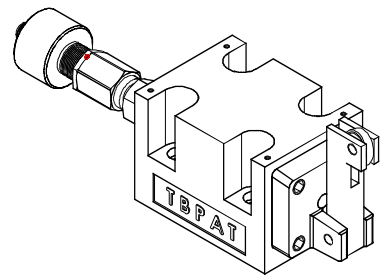

## ◆ SPECIFICATIONS 規 格

| Model Number<br>型式號碼                 | Maximum Pressure<br>最大壓力 bar | Connecting PT<br>適用管徑             | Maximum Flow<br>最大流量 lpm | Weight<br>重量 Kg |
|--------------------------------------|------------------------------|-----------------------------------|--------------------------|-----------------|
| DCG-2B2-02G-20-GIV                   | 315 (4500 psi)               | 1/4"                              | 30 (7.93 gpm)            | 2.0 (4.4 lbs)   |
| DCG-2B2-02G-10-GIV                   |                              |                                   | 70 (18.49 gpm)           | 3.9 (8.6 lbs)   |
| DCG-2B2-03G-10-GIV                   |                              | 3/8"                              | 120 (31.70 gpm)          | 3.9 (8.6 lbs)   |
| <b>Fluid Type</b> 流體型式               |                              | ISO VG 32, 46, 68                 |                          |                 |
| <b>Viscosity</b> 黏性 cSt              |                              | 10~400 (59~1854 SSU)              |                          |                 |
| <b>Operating Temperature</b> 操作溫度 °C |                              | -15~70 (-5~158 °F)                |                          |                 |
| <b>Contamination Level</b> 污染標準      |                              | ISO4406. 21/19/16 NAS1638,10      |                          |                 |
| <b>Surface Treatment</b> 表面處理        |                              | Zinc Phosphate Compound 鋅 磷酸鹽 化合物 |                          |                 |

● All screws with metric measure , if require inch measure , please contact us. 所附螺絲皆為公制標準規格品，若需英制螺絲請另外備註說明。

## ◆ HOW TO ORDER 編號說明

|          |          |          |          |          |          |          |
|----------|----------|----------|----------|----------|----------|----------|
| <b>1</b> | <b>2</b> | <b>3</b> | <b>4</b> | <b>5</b> | <b>6</b> | <b>7</b> |
| DCG      | — 02     | G        | — Y      | — 10     | — **     | — GIV    |

### 1 VALVE SERIES 系列名稱

DCG= Cam Operated Directional Valves 凸輪行程換向閥  
(Position Switch Included) 附位置感應器

### 2 SUBPLATE MOUNTING SIZE: 稱呼口徑

02=1/4"(6mm)  
ISO CETOP3  
DIN NG 6  
NFPA D03

### 3 CONNECTING TYPE 連接型式

G:TYPE:BASEPLATE MOUNTING TYPE 板式連接  
T:TYPE:THREADING TYPE (Only for 20 type)  
螺紋連接(只生產20型)

### 4 ROLLER POSITION 輪轉方向

Y : Standard Y : 標準品  
R : (Roller position information please refer to the page 336 )  
S : (Roller position information please refer to the page 336 )  
(輪轉方向資料請查336頁面)

### 5 DESIGN NO 設計編號

| Number<br>編號 | Spool Types<br>滑柱型式 |
|--------------|---------------------|
| 10           |                     |
| 20           | See 6 Mark 見 6 標註   |

### 6 MARK 標註

| 20 Type<br>20型 | Model Symbol<br>型式記號 |
|----------------|----------------------|
| NO Open<br>常開  |                      |
| NC Close<br>常閉 |                      |

※ The function only for 20 type 只有20型有此功能

### 7 DESIGN NO 設計編號

GIV :Position Switch Included 附位置感應器

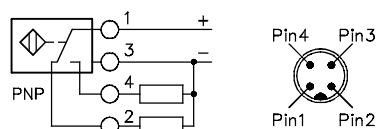

# CAM OPERATED DIRECTIONAL VALVES

凸輪行程換向閥 ( 附位置感應器 )

DCG - - GIV SERIES ( Position Switch Included )

## ◆ DIMENSIONS 外型尺寸圖

### DCG-2B2-02G-10-GIV

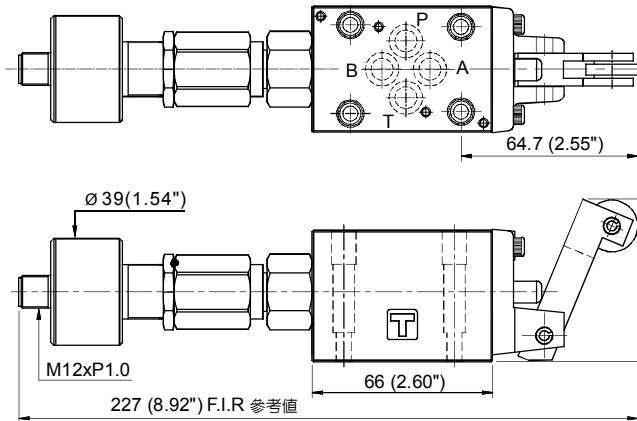

## ◆ Mounting Interface 基座尺寸圖

ISO 4401-AB-03-4-A

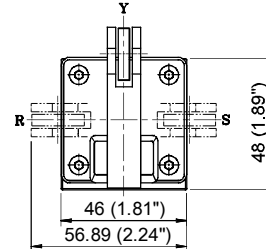

## ◆ DIMENSIONS 外型尺寸圖

### DCG-2B2-02G-20-GIV

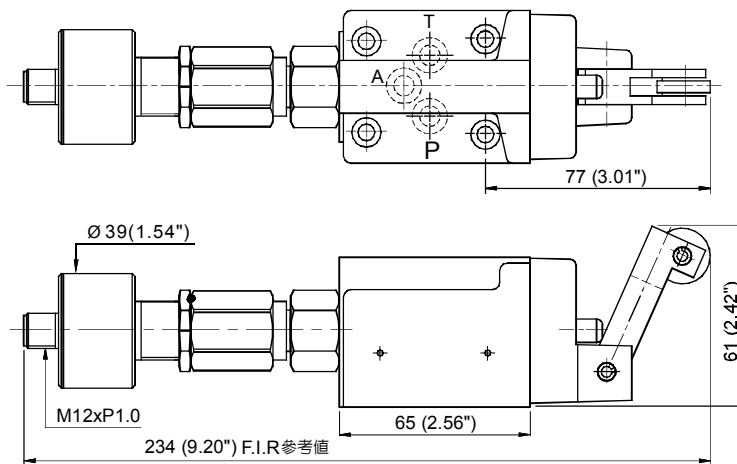

## ◆ Mounting Interface 基座尺寸圖

ISO 4401-AB-03-4-A

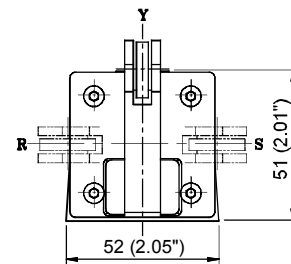

## ◆ DIMENSIONS 外型尺寸圖

### DCG-2B2-03G-10-GIV

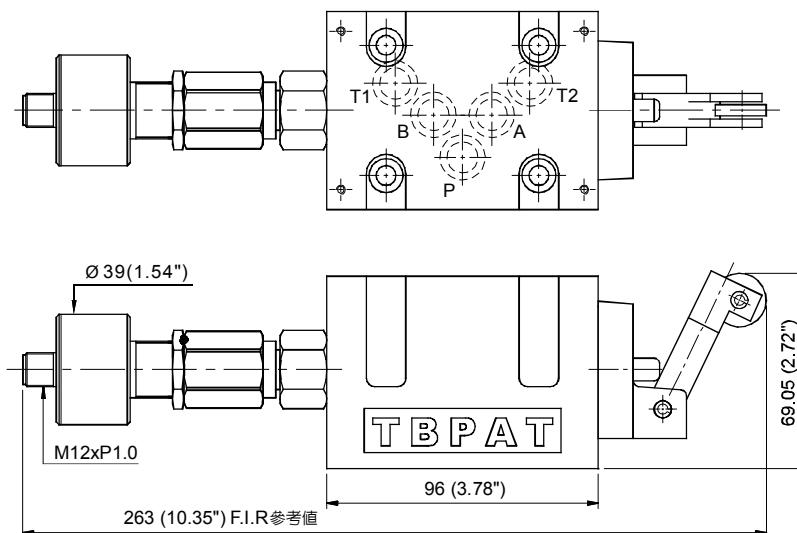

## ◆ Mounting Interface 基座尺寸圖

ISO 4401-AC-05-4-A

