

◆ **MODEL** 型 式

VRCO-01

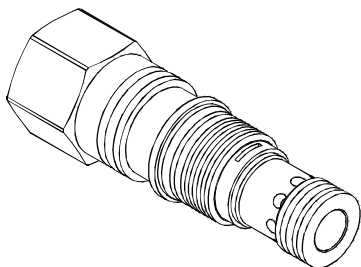

◆ **DESCRIPTION** 說明

Internal Pilot (VE):
Normally closed modulating elements with an internal orifice between port 1 and port 3 can be used as a main-stage relief valve. The valve can be controlled remotely using a pilot relief or pilot solenoid valve.

External Pilot :

Normally closed modulating elements without an internal orifice act as a bypass compensator to maintain a constant pressure drop across an orifice, regardless of variations in upstream or downstream pressure.

內部導壓(VE) :

此閥為常閉並在口1到口3之間內置節流孔的調節元件.此閥可作主級溢流閥,並可用先導溢流閥或電磁閥來遠程控制.

外部導壓 :

此閥為無內置節流孔的常閉調節單元,用來作為旁路壓力補償器以確保流過節流孔的壓降保持恆定,不受進出口壓力變化影響.

◆ **SPECIFICATIONS** 規 格

Model Number 型式號碼	Maximum Pressure 最大壓力 bar	Maximum Flow 最大流量 lpm	Weight 重量 Kg
VRCO-01	350 (5076 psi)	30 (7.93 gpm)	0.1 (0.22lbs)
Fluid Type 流體型式		ISO VG 32, 46, 68	
Viscosity 黏性 cSt		10~400 (59~1854 SSU)	
Operating Temperature 操作溫度 °C		-15~70 (-5~158 °F)	
Contamination Level 污染標準		ISO4406. 21/19/16 NAS1638,10	

◆ **HOW TO ORDER** 編號說明

1	2	3	4
VRCO	01	*	*

1 VALVE SERIES 系列名稱

VRCO =VRCO SERIES CARTRIDGE
CONSTANT-PRESSURE TYPE RELIEF VALVES
插入式定壓型調壓閥

2 SUBPLATE MOUNTING SIZE 稱呼口徑

01 :T-163A
Cavity 孔口:CST-163A
See Page Appendixes-A_008
見附錄A_008頁面

3 VERSION 形式

VE : INTERNAL PILOT VE : 內部導壓
NONE : EXTERNAL PILOT 無 : 外部導壓

4 CRACKING PRESSURE 彈簧壓力

Order 編號	Cracking pressure 彈簧壓力
35	3.5 bar (50psi)
70	7.0 bar (100psi)
140	14.0 bar (200psi)

◆ **CONTROL PORT(S)** 動作形式

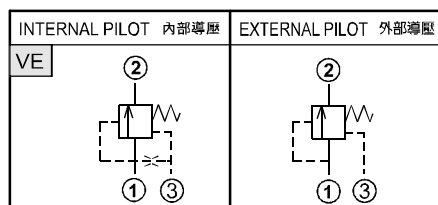

◆ **DIMENSIONS** 外型尺寸圖

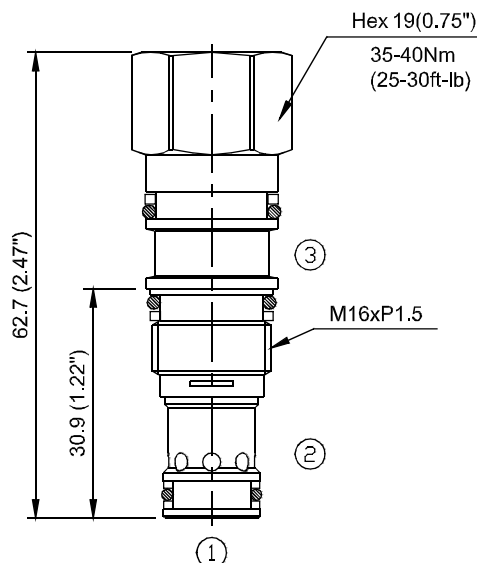

PRESSURE CONTROL VALVES 壓力控制閥

VRCO SERIES CARTRIDGE CONSTANT-PRESSURE TYPE RELIEF VALVES VRCO 系列插入式定壓型調壓閥

◆ MODEL 型式 VRCO-02

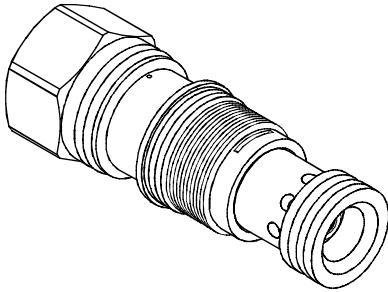

◆ DESCRIPTION 說明

Internal Pilot (VE):
Normally closed modulating elements with an internal orifice between port 1 and port 3 can be used as a main-stage relief valve. The valve can be controlled remotely using a pilot relief or pilot solenoid valve.

External Pilot :
Normally closed modulating elements without an internal orifice act as a bypass compensator to maintain a constant pressure drop across an orifice, regardless of variations in upstream or downstream pressure.

內部導壓 (VE) :
此閥為常閉並在口1到口3之間內置節流孔的調節元件。此閥可作主級溢流閥，並可用先導溢流閥或電磁閥來遠程控制。

外部導壓 :
此閥為無內置節流孔的常閉調節單元，用來作為旁路壓力補償器以確保流過節流孔的壓降保持恆定，不受進出口壓力變化影響。

◆ SPECIFICATIONS 規格

Model Number 型式號碼	Maximum Pressure 最大壓力 bar	Maximum Flow 最大流量 lpm	Weight 重量 Kg
VRCO-02	350 (5076 psi)	60 (15.85 gpm)	0.15 (0.33lbs)
Fluid Type 流體型式		ISO VG 32, 46, 68	
Viscosity 黏性 cSt		10~400 (59~1854 SSU)	
Operating Temperature 操作溫度 °C		-15~70 (-5~158 °F)	
Contamination Level 污染標準		ISO4406. 21/19/16 NAS1638,10	

◆ HOW TO ORDER 編號說明

1	2	3	4
VRCO	02	*	*

1 VALVE SERIES 系列名稱

VRCO =VRCO SERIES CARTRIDGE
CONSTANT-PRESSURE TYPE RELIEF VALVES
插入式定壓型調壓閥

2 SUBPLATE MOUNTING SIZE 稱呼口徑

02 :T-11A
Cavity 孔口:CST-11A
See Page Appendixes-A_006
見附錄A_006 頁面

3 VERSION 型式

VE : INTERNAL PILOT VE : 內部導壓
NONE : EXTERNAL PILOT 無 : 外部導壓

4 CRACKING PRESSURE 彈簧壓力

Order 編號	Cracking pressure 彈簧壓力
35	3.5 bar (50psi)
70	7.0 bar (100psi)
140	14.0 bar (200psi)

◆ CONTROL PORT(S) 動作形式

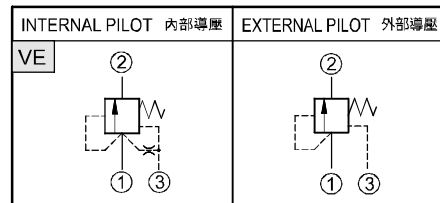

◆ DIMENSIONS 外型尺寸圖

