

DIRECTIONAL VALVES 方向閥

WV SERIES JOINTED SHUTTLE VALVES WV系列接頭式梭動閥

◆ MODEL 型式

WV12-S

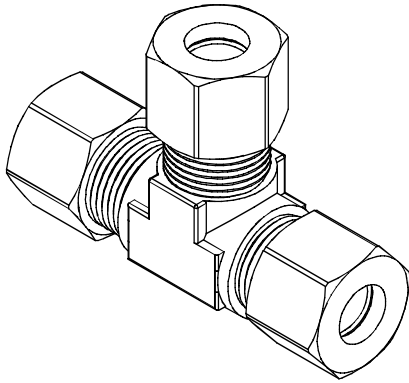

◆ PERFORMANCE 特性曲線

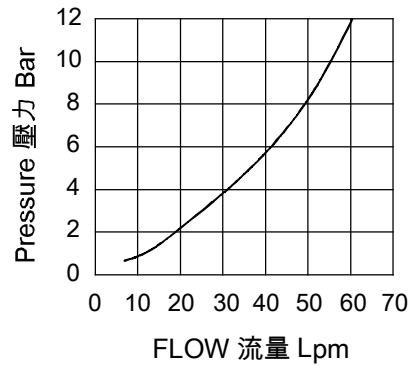

◆ SPECIFICATIONS 規格

Model Number 型式號碼	Maximum Pressure 最大壓力 bar	Maximum Flow 最大流量 Lpm	Weight 重量 Kg
WV12-S	315 (4569 psi)	40 (10.57 gpm)	0.3 (0.66 bs)
Fluid Type 流體型式		ISO VG 32,46,68	
Viscosity 黏性 cSt		10~400 (59~1854SSU)	
Operating Temperature 操作溫度 °C		-15~70 (-5~158°F)	
Contamination Level 污染標準		β ₁₀ ≥75, Under NAS Class 12,25μ	

◆ HOW TO ORDER 編號說明

1	2	3
WV	12	S

1 VALVE SERIES 系列名稱

WV = JOINTED SHUTTLE VALVE
接頭式梭動閥

◆ CONTROL PORT(S) 動作形式

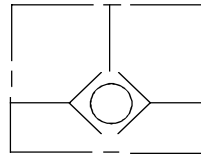

2 SUBPLATE MOUNTING SIZE 稱呼口徑

12 = 鋼管直徑(m/m)

3 DESIGN NO 設計編號

◆ DIMENSIONS 外型尺寸圖

外型尺寸圖

